

a 120 by 80 4800
 b 125 by 18 1125
 c. 152 by 50 3800 150
 d 238 by 84 80 16779 230
 e. 90 by 26 1170
 f 275 by 60 59 14850
 g 200 by 48 47 9000 198
 h. 376 by 46 56 19176 45

120 13
 40 90
 4800 1170
 1125 875
 9 54
 1125 1100
 76 1275
 50 14850
 3800 90
 119 100
 141 9000
 119 376
 476 51
 119 376
 16779 1880
 19176

438
 72700
 x 668
 xx
 441 - 140
 379 - 55
 62 - 85

I make R. Houghts 416 acres 135 p¹²

125 25 1100 1061 1000
 9 150 117 53 161
 1145 1250 805 825 188
 25 1265 1375 188
 3750 13455 14575 188
 18988

56
 60
 116
 52
 70
 120
 67
 56
 100
 120
 60
 56
 116
 49
 61
 110

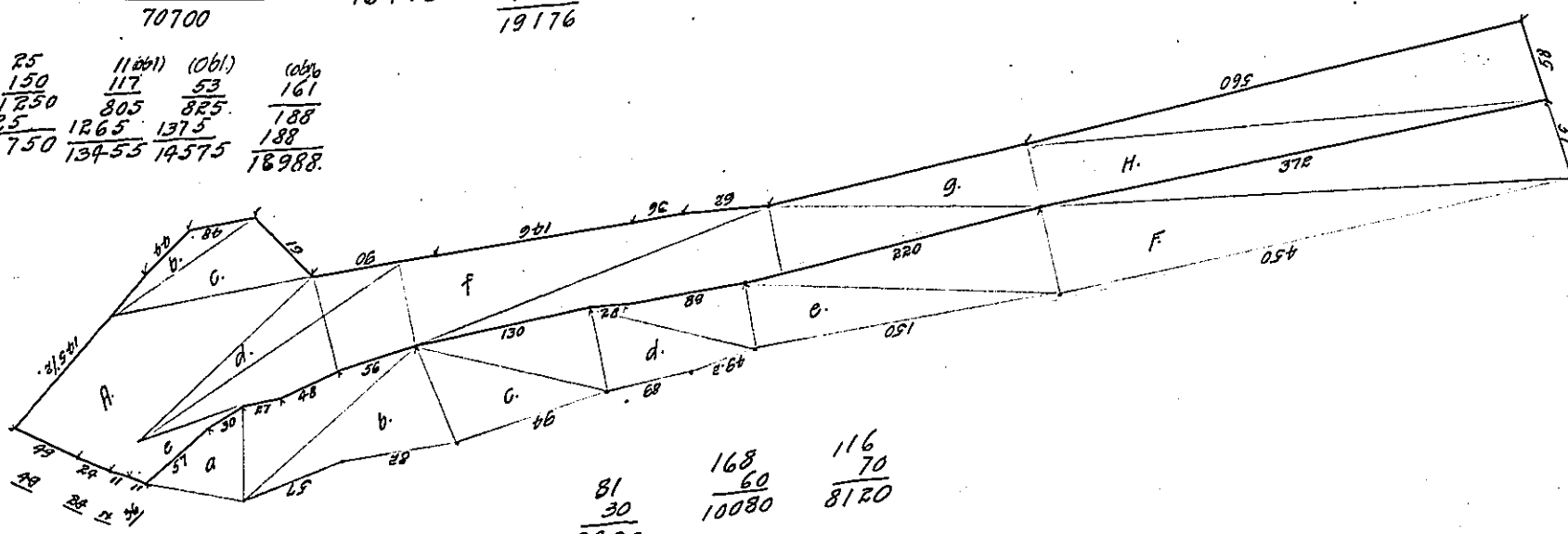

81 168 116
 30 60 70
 2930 10080 8120
 125 225 116
 50 55 190
 6250 1125 10440
 1125 116
 12375 22040

a 81 by 60 2430
 b 168 by 120 10080
 c. 140 by 116 8120
 d. 126 100 6250
 e. 225 110 12375
 f. 380 116 22040

438
 6428/5 (383-15)
 1668
 xx
 3802

IN TESTIMONY that the above is a copy of the original remaining on file in the Department of Internal Affairs of Pennsylvania, made conformably to an Act of Assembly approved the 16th day of February, 1833, I have hereunto set my Hand and caused the Seal of said Department to be affixed at Harrisburg, this

eighteenth day of January 1911.
 Henry Houder
 Secretary of Internal Affairs.